

PROPOSED PLAN OF A G+VII STORIED RESIDENTIAL BUILDING AT J.L NO- 25, TOUZI NO- 56, R.S. NO . 3, COMPRIED IN R.S. DAG NO- 194 UNDER L.R. KHATIAN NO- 2760 UNDER K.M.C. PREMISES NO.- 3453, AT MOUZA- NAYABAD, WARD No.- 109, BOROUGH - XII, KOLKATA- 700094, P.S.- PANCHASAYAR.

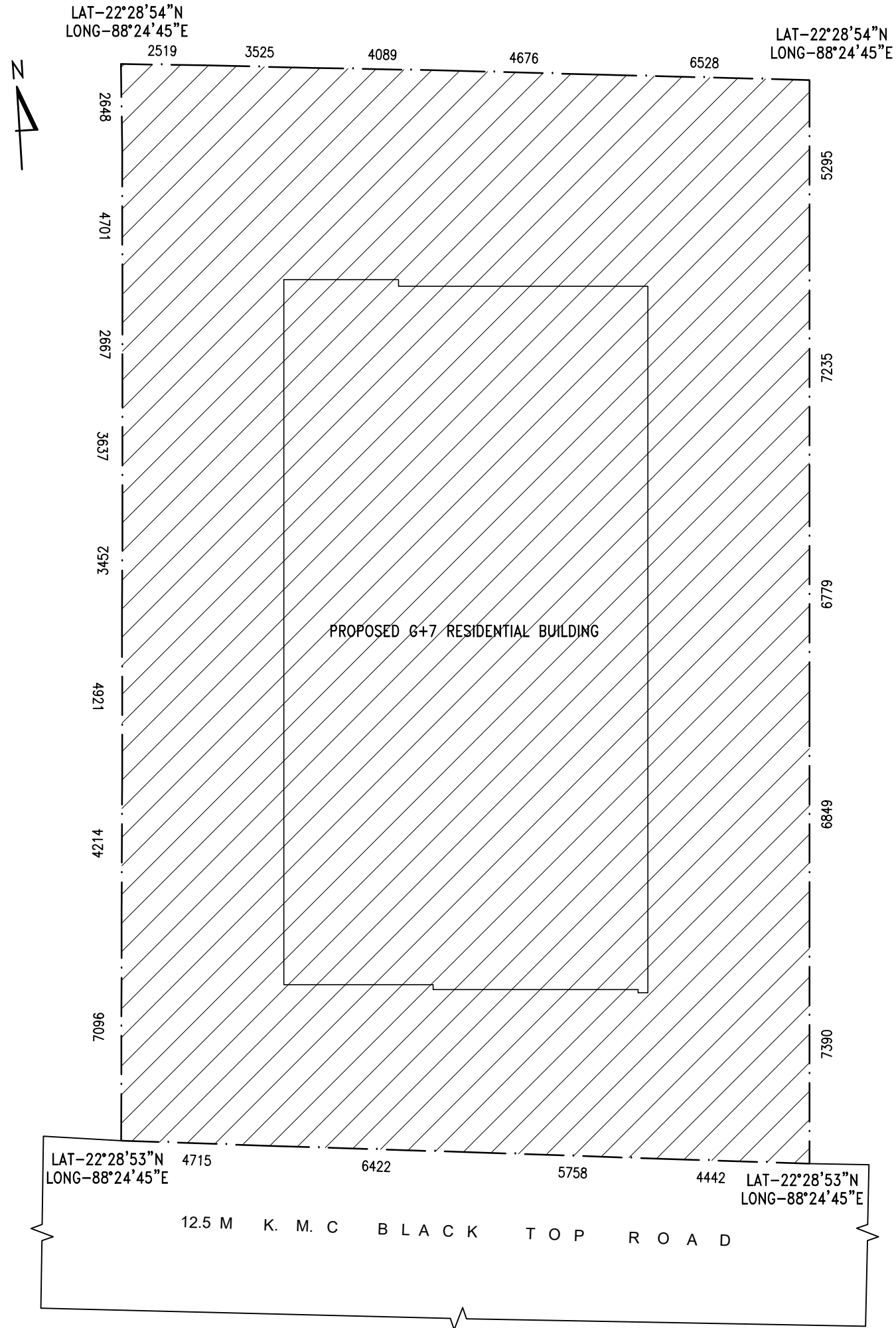

LOCATION PLAN

LAT-22°28'53"N
 LONG-88°24'45"E

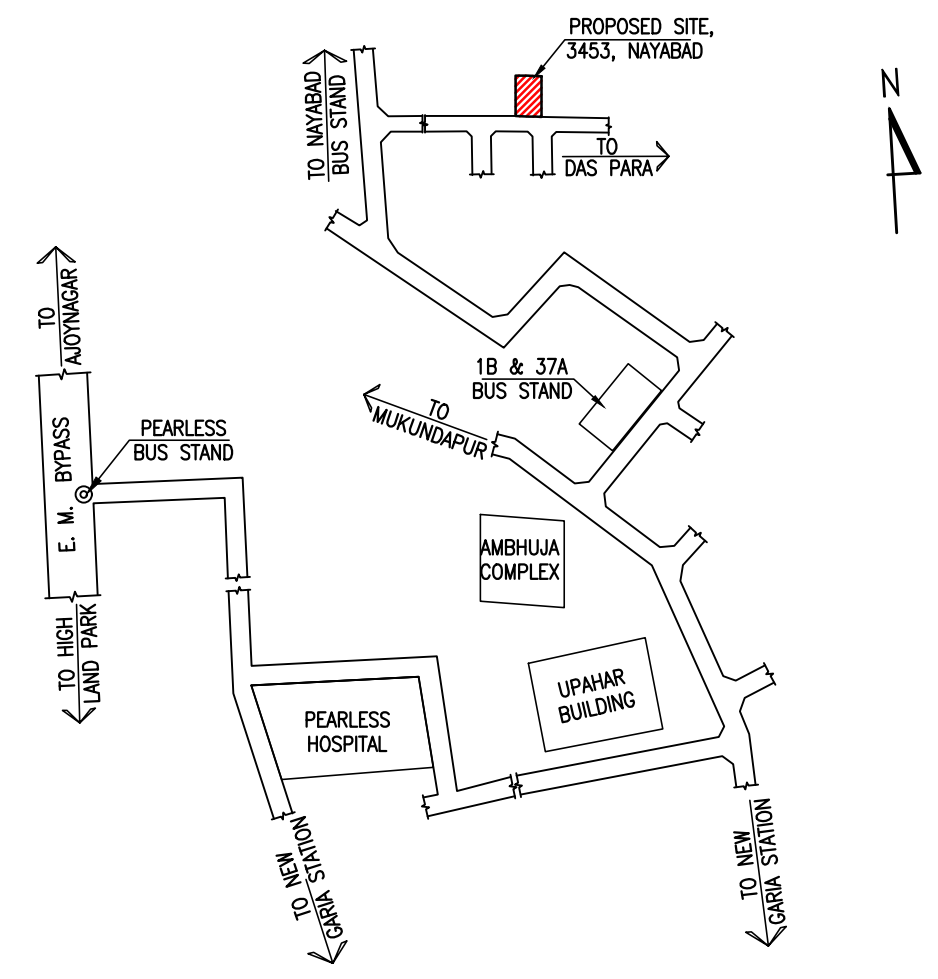

SIGNATURE OF OWNER

SIGNATURE OF ARCHITECT